



Dhanashri Vishwa Residential Complex



Giriraj Developers

Maha Rera Regd. No.: P552200020495

100% Legal as per Kopergaon Municipal Council Sanction Plan

Dhanashri Vishwa Residential Complex is intended for intelligent and practical living. The unique design and layout of Dhanashri Vishwa Residential Complex makes life immensely comfortable with plenty of spaces for stress free living.

Dhanashri Vishwa Residential Complex is a perfect abode with a spiritual feel having the infamous “Shukracharya Temple” just a block away. One will never have to go too far to seek divine intervention with the Temple so close to home. With water shortages a common scene in societies these days, a home in Dhanashri Vishwa Residential Complex comes as a blessing in more ways than one with 24 hours supply of water through tube well. Away from the pollutions of the city at the same time connected at just a distance of 5-7 mins drive from Kopargaon, it is a perfect dwelling for those seeking calm & serenity in life, conveniently located at a distance of 15 km. by road from the Airport & Shirdi Temple.

Designed to the specifications of global best practices with stringent environment specifications, Dhanashri Vishwa Residential Complex promises you the good life in the most sort-after and up-coming locations of Kopargaon. In the heart of nature with peaceful location, bright blue skies, amidst the plentiful goodness of nature.

Luxurious Material Details

- 2'x2' premium quality vitrified tiles flooring.
- Walls and ceiling rendered in plaster of paris or gypsum finish.
- Oil bound distemper to walls and ceiling
- Granite top kitchen platform with stainless steel sink
- Decorative kitchen tiles above platform
- Moulded /ready made kitchen cabinet
- Non skid floor tiles and designer wall tiles in toilets
- Toilets with premium quality fittings and sanitary ware
- Toilets with water heaters / geysers
- Veneer finished/ laminated flush doors
- Anodized / powder coated aluminum windows with granite lining
- Adequate light points in all rooms
- Parking area on ground floor will have chequered tiles flooring
- Entrance foyer with vitrified floor tiles
- Branded lift with modern décor
- Surrounding compound wall with decorative entrance gate
- Landscaped garden within compound
- **Solar Electricity : Solar generated electrical power supply for common usage. Hence reduced or no electricity cost for common lighting, lift, common electric motors, compound lighting etc...**



1 Bhk Apartment Plan



9 M. W. R O A D

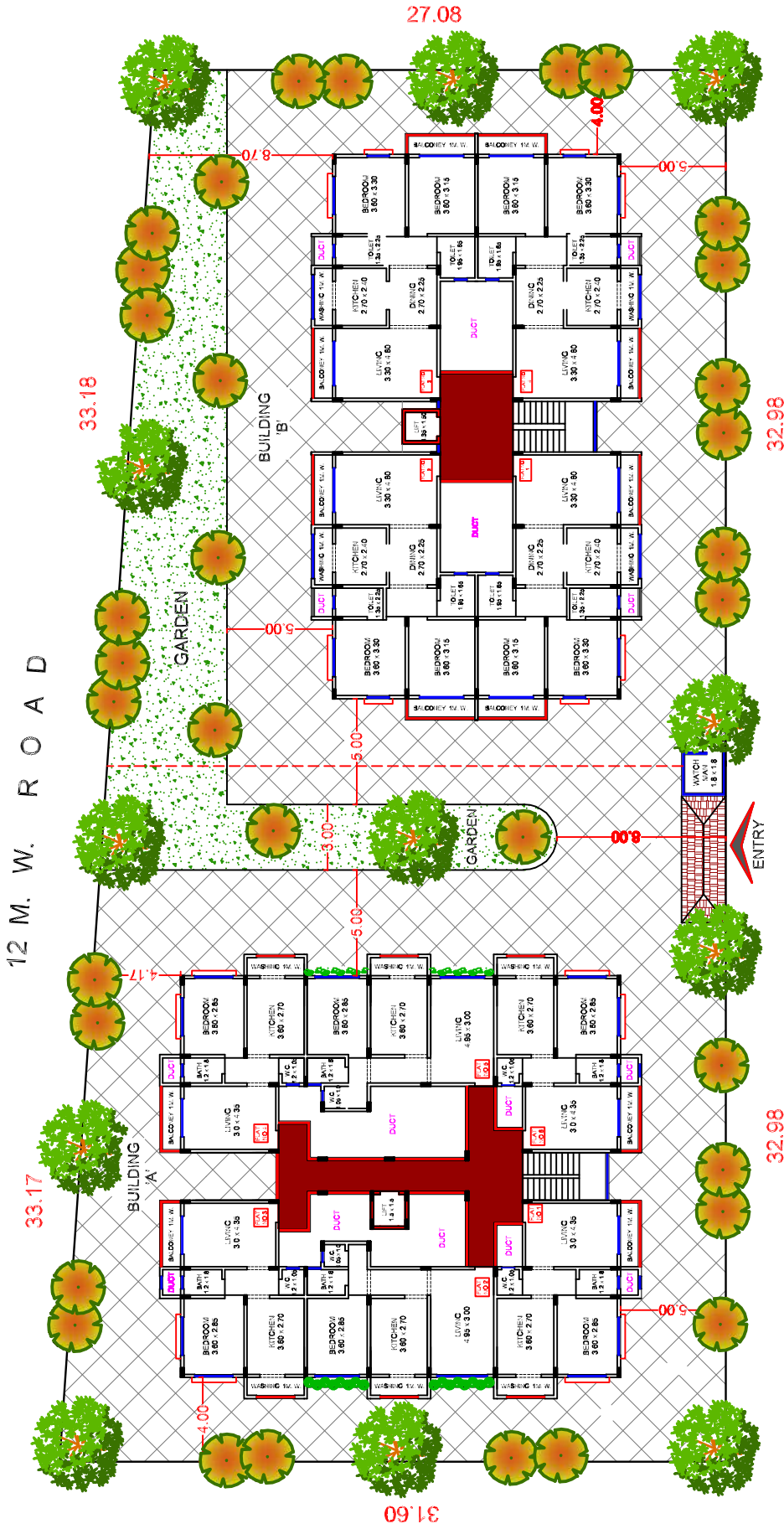

Proposed Building

“Giri Niwas”

Not Yet Registered In Maha Rera

“Giri Darshan”

Maha Rera Regd. No.: P552200020495



9 M. W. R O A D

